

No. 84. 12 TOWNSHIPS. Printed and for Sale by Glass & Prothome Company, Portland, Or. 161661D

TOWNSHIP NO. 25 N.

TOWNSHIP NO. 24 N.

No. 84. 12 TOWNSHIPS. Printed and for Sale by Glass & Prothome Company, Portland, Or. 161661D

TOWNSHIP NO. 23 N.

TOWNSHIP NO. 22 N.

TOWNSHIP NO. 21 N.

TOWNSHIP NO. 20 N.

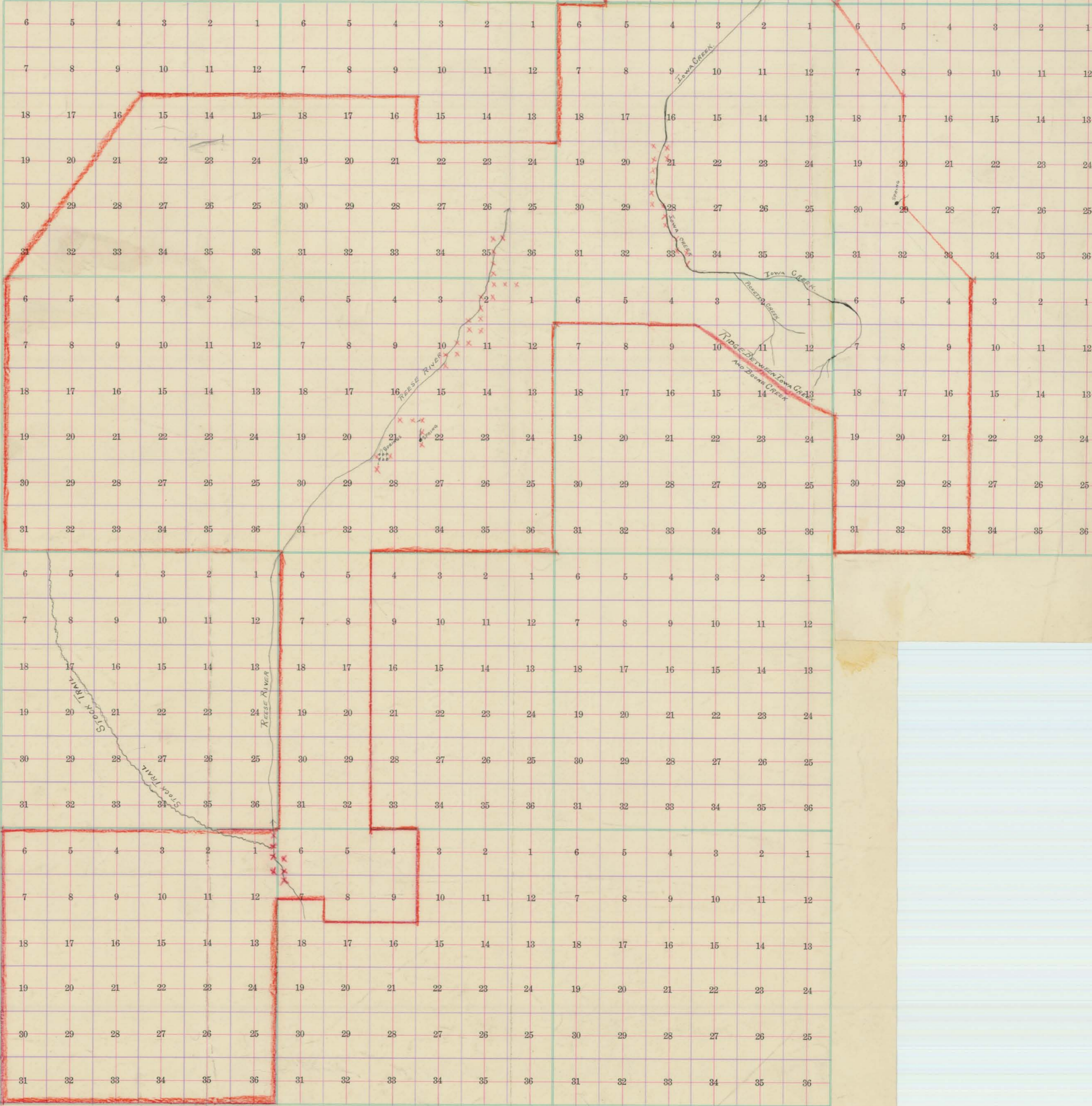

— BOUNDARY OF RANGE OF J. C. PHILLIPI IN LANDER COUNTY, NEVADA.  
X PATENTED LAND OF J. C. PHILLIPI.