

CALIFORNIA NEVADA

RANGE MAP

E. J. FEE

Fort Bidwell, California.

Supplementary to

FEE & MARTIN

Range Map

Serial No 90-30

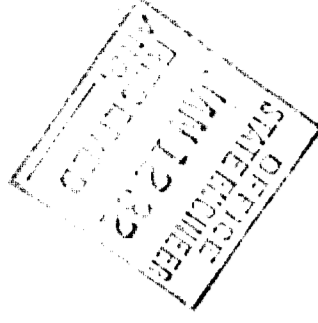

FILED
Jan 12, 1932
STATE ENGINEER OF CALIFORNIA

Jan 12 1932

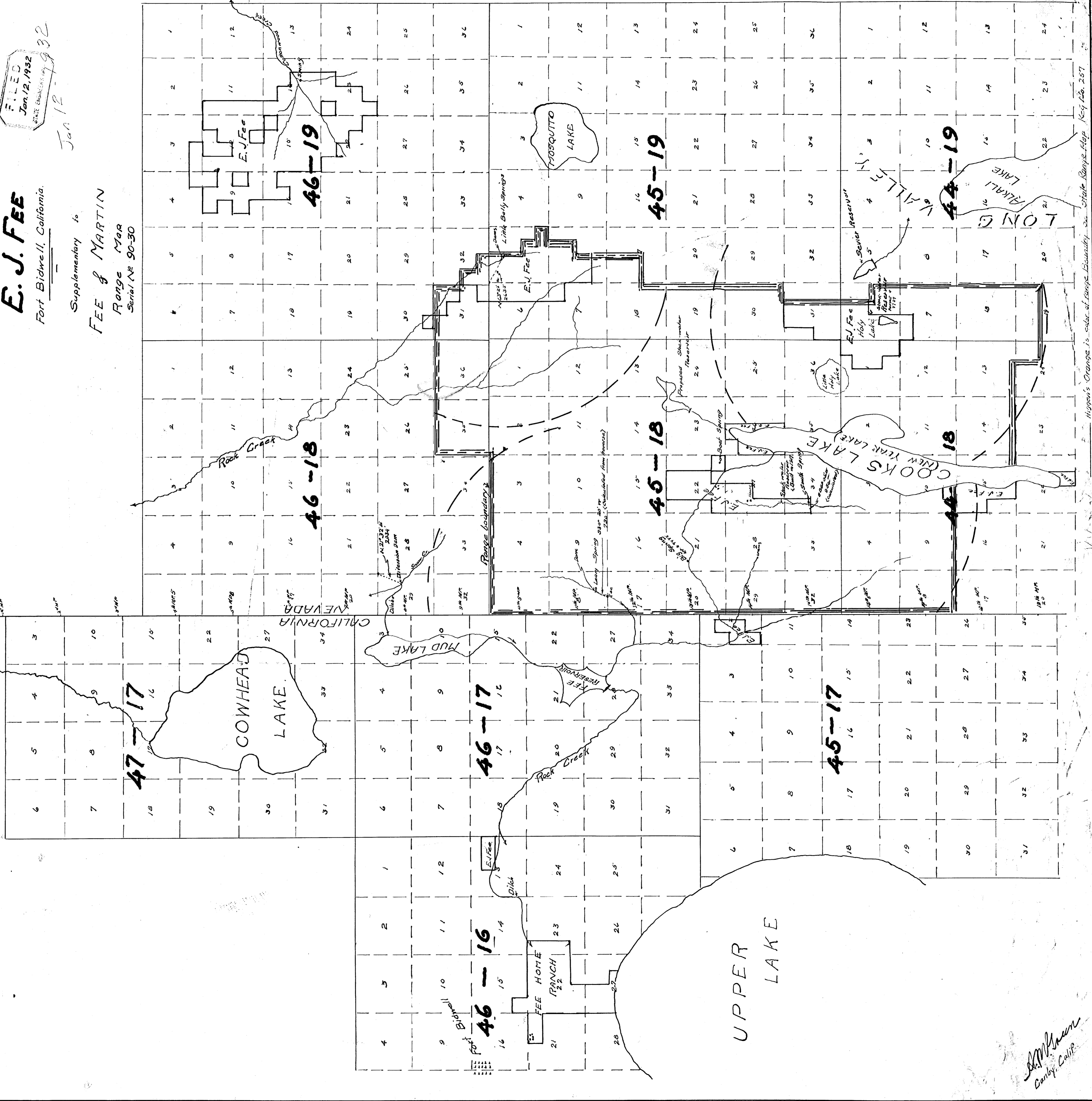

E. J. Fee
County, Calif.

Higgin's Orange is color of range boundary on State Range Map No. 4, 207