

NORTH  
Township No. 44 N. of Range No. 38 E. of Mt. Diablo Meridian

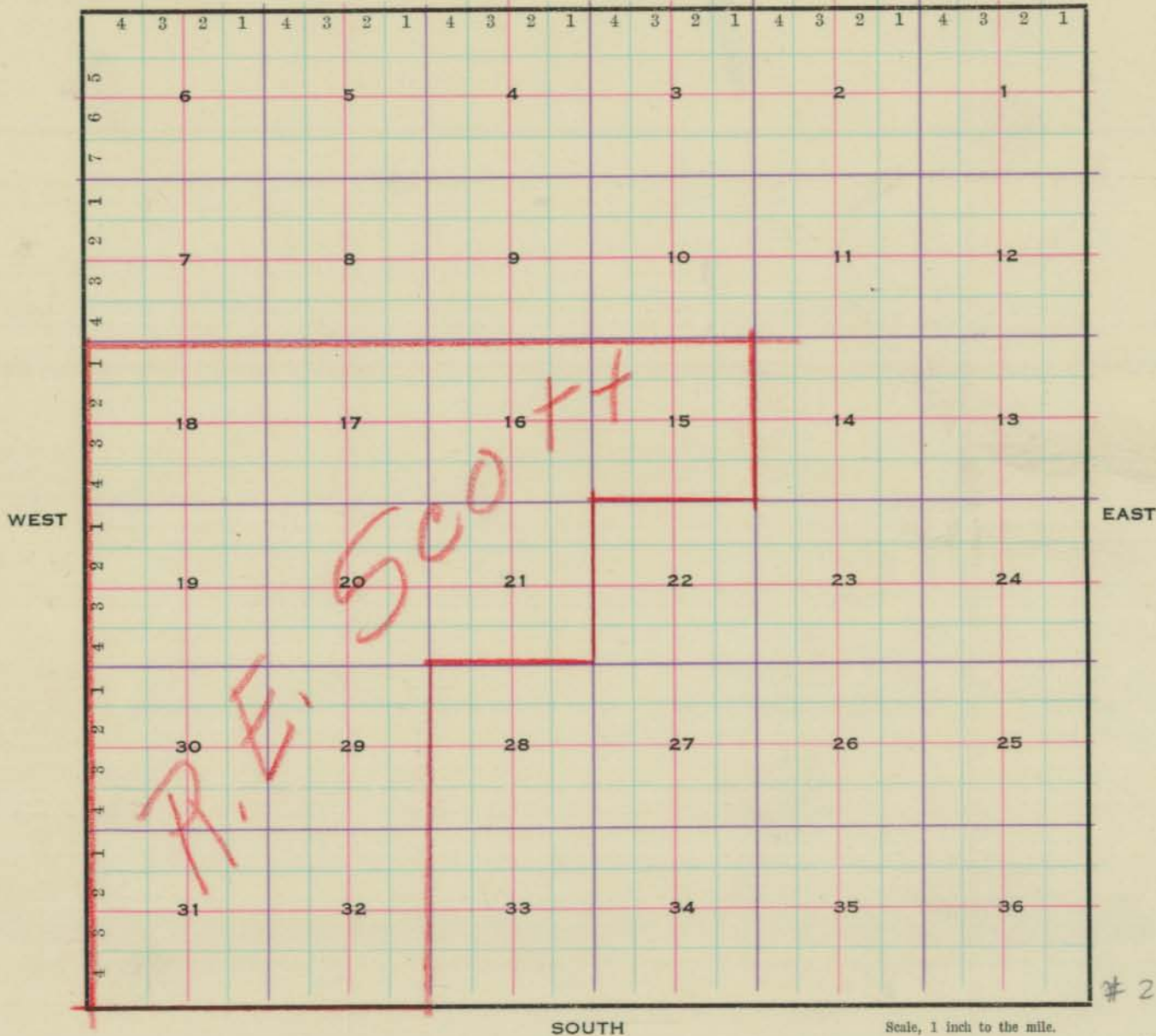

SOUTH

Scale, 1 inch to the mile.

**FILED**  
June 28, 1930  
STATE ENGINEER'S OFFICE

RECEIVED  
JUN 28 1930  
STATE ENGINEER'S OFFICE

# 221

462-34

F. R. O'LEARY, C. E.  
Humboldt Co. Surveyor

462-34