

State of Nevada ss.
 County of Washoe, ss.
 I, L.H. Taylor, being first duly sworn, depose and say: that the above map is a true and accurate plat of the stock watering and range rights of John G. Taylor, Inc., pursuant to the Stock Watering Act of Nevada, 1925, as copied from the official township plats of the United States Public Land Surveys on file in the United States Land Office; that the map was made at the instance of John G. Taylor, Inc.; that it shows the streams and springs as shown on said official plats.
 L.H. Taylor,
 State Water Right Surveyor.
 Subscribed and sworn to before me this 23rd day of April, 1927.
 Notary Public in and for Washoe County, Nevada.

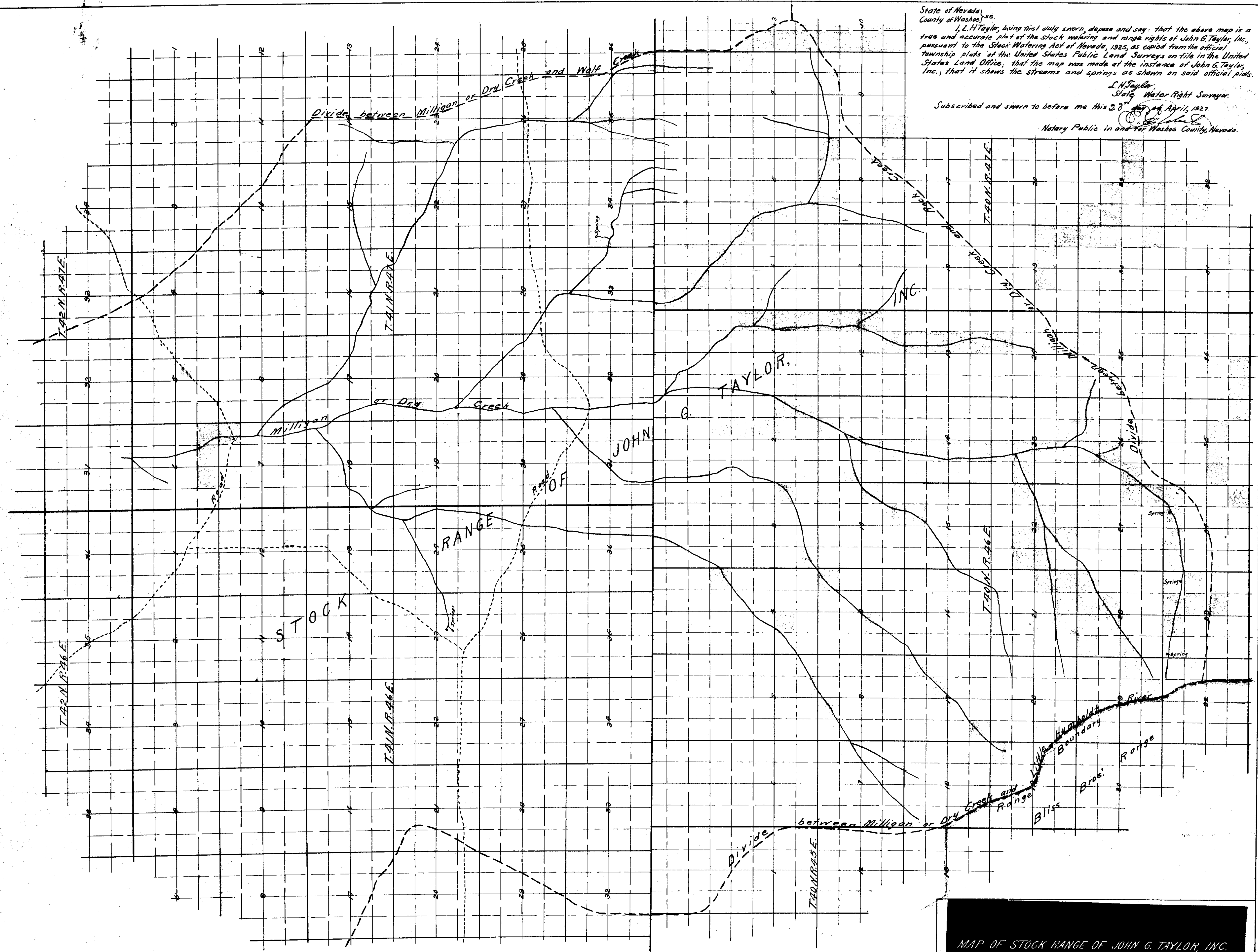

□ Lands owned by John G. Taylor, Inc.

MAP OF STOCK RANGE OF JOHN G. TAYLOR, INC.
 SCALE 2" = 1 MILE.
 SHEET 4 OF 9.

H-14