

(W.S. Survey of 1925)

Township No. 14. N. - Range No. 51 E. Mer. MT. Diablo.

1 unit west of T. line

Cattle Range line

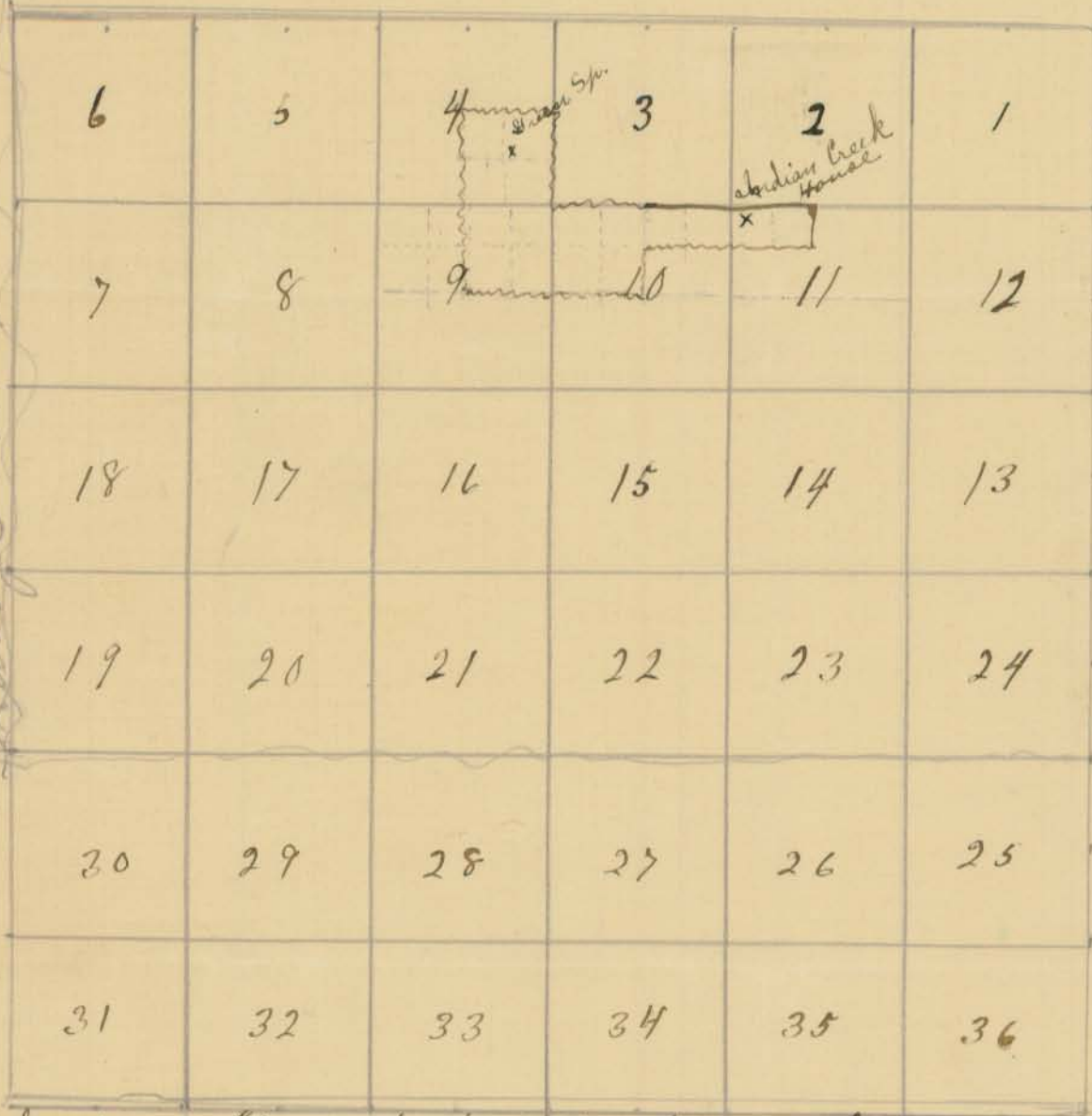

My Stock raising Homestead outlined in ink is

S.E. $\frac{1}{4}$ Sec. 4 - T. 14, R. 51 E.

N.E. $\frac{1}{4}$.. 9 -

N.W. $\frac{1}{4}$.. 10 -

N $\frac{1}{2}$ of N.E. $\frac{1}{4}$ Sec. 10 - T. 14 - R. 51 E

N $\frac{1}{2}$ of N.W. $\frac{1}{4}$.. 11 -

Township No 16-N-, R. 51E. -

W. H. H. 56 Mer.

Stock
or
Cattle Range lines -

6	5	4	3	2	1
7	8	9	10	11	12
18	17	16	15	14	13
19	20	21	22	23	24
31	29	28	27	26	25
31	32	33	34	35	36

Spring No. 4
x
ASSIGNED

x -> Kinkhead Sp.

Spring No. 4 is Upper Davis Sp.
" " 5 is Lower Davis Sp.

As I haven't the papers of above Springs with me
and this T. is not surveyed - the location of the
Springs marked is - approximately.

J. 6

1	6	5	4	3	2	1
12	7	8	9	10	11	12
13	18	17	16	15	14	13
24	19	20	21	22	23	24
25	30	29	28	27 ^{gas}	26 ^{gas}	25
36	31	32	33	34	35	36

This map shows Range asked.

J. 15

1	6	5	4	3 ^{xms}	2	1
12	7	8	9	10	11	12
13	18	17	16	15	14	13
24	19	20	21	22 ^{gas}	23	24
25	30	29	28	27	26	25
36	31	32	33	34 ^{x Parker Homestead}	35	36

ASSIGNED

Back raising Homestead.

J. 14

6	5	4	3	2	1	
12	7	8	7	10	11	12
13	18	17	16	15	14	13
24	19	20	21	22	23	24
25	30	29	28	27	26	25
36	31	32	33	34	35	36

Map of Range Claimed by Mrs. Ross A. Parker Potts, Nev.

ASSIGNED To Emma and Harold Schaefer

257-34

R 51 is Mts. I have marked to top of Mts.

Range 52 is valley. Range asked for

Township No. 15. N. Range No. 51 E, Mer. Mt. Diablo.

Cattle Range - line and west of this

6	5	4	3	2	1
7	8	9	10	11	12
18	17	16	15	14	13
19	20	21	22	23	24
30	29	28	27	26	25
31	32	33	34	35	36

No. 2
* Spr.

No. 3 Spr.

* No. 3 Spr.

* Parkers
Cabin

Eureka Co.
Nye Co.

- Spring No. 1 Cockloun - = in NW $\frac{1}{4}$ S.W. $\frac{1}{4}$ of Sec. 23 - T. 15 N. R. 51 E.
- Spring No 3 - Number Four. = SE $\frac{1}{4}$ of NE $\frac{1}{4}$ - Sec 3 - " " "
- Spring No. 2 - Kin head or Middle Field Spr.
- " " S.E. $\frac{1}{4}$ of S.E. $\frac{1}{4}$ Sec. 34 - T. 16 N. - R. 51, E.

DESIGNED

(W. S. Surveyed in 1925.)