

North
Scale 1 in. to 1 mile.

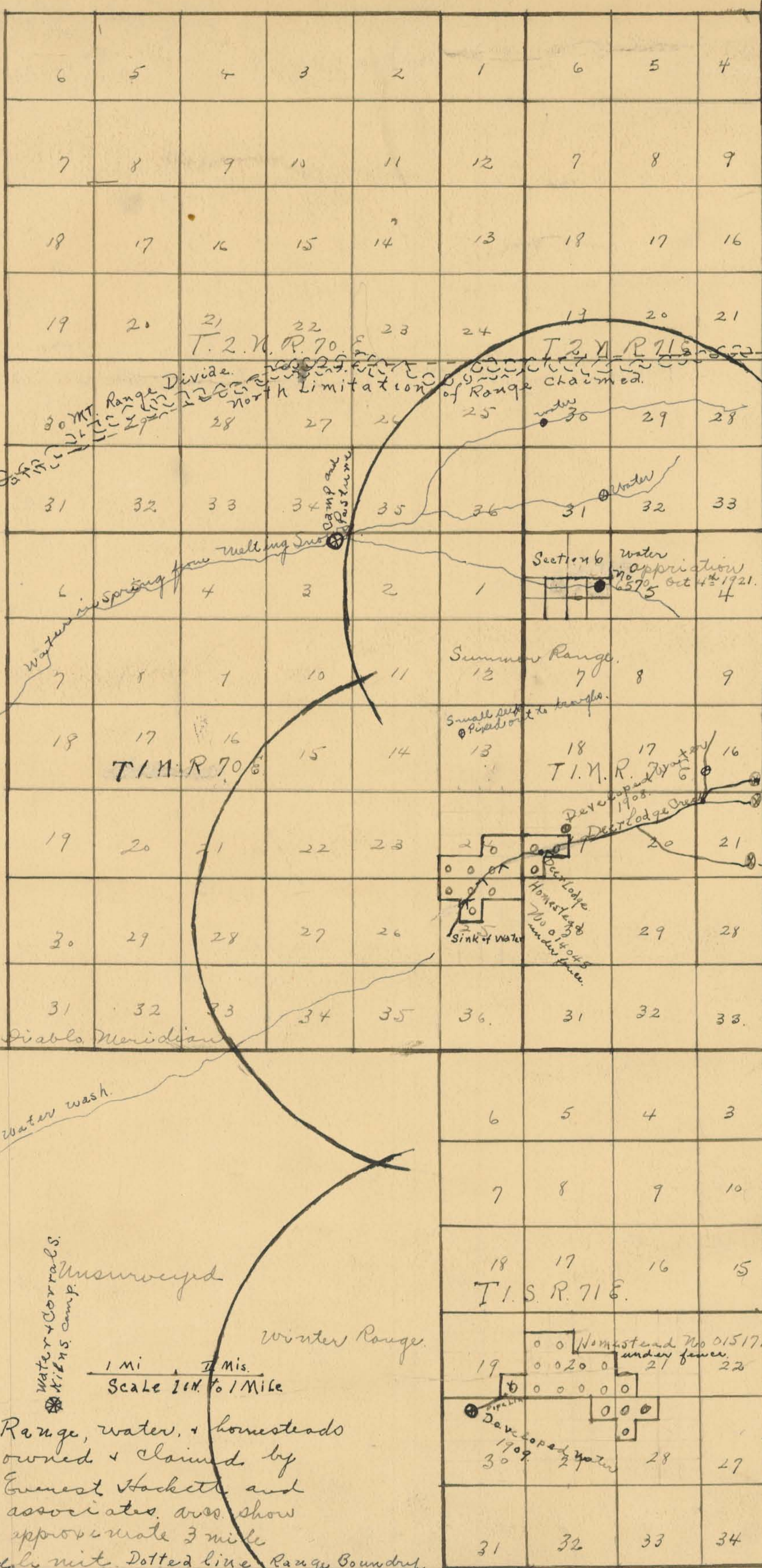

approximate west line road.
Winter Range. No water.
Unsurveyed.

Nevada Line.
STAT. LINE. East Base of R.R. 1
Water appropriation No 1748
7/11/1910.
Points of Diversion.

Water + Corral's at 1/2 camp
Unsurveyed
1 mi 1/2 mi
Scale 1 in. to 1 mile
Range, water, + homesteads owned + claimed by Everest Hackett and associates. Does show approximate 3 mile limit. Dotted line Range Boundary.

This line extends to intersection with Stat line

Homestead No 01517 under fence
Developed water 1909
Sink of water
Unsurveyed.

Range Map of Everest Hackett and Associates, Care Everest Hackett, Box 37 Modena, Utah.

OFFICE STATE ENGINEER
FEB 23 '28
RECEIVED ANS.

222-30