

CARSON RIVER CLAIMS 40, 55, 462 & 464

Portions of Sections 2, 3 & 15; T. 11 N., R. 20 E., M.D.B. & M.
And a Portion of Section 34; T. 12 N., R 20 E., M.D.B. & M.

CLAIM 55/464*

PARCEL	AREA (Acres)
See Note	
Total = 290.00 acres	

CLAIM 462

PARCEL	AREA (Acres)
31-010-06	0.66
31-100-04	0.52
31-100-05	4.04
31-100-07	32.98
Total = 38.40 acres	

CLAIM 464/55*

PARCEL	AREA (Acres)
See Note	
Total = 228.00 acres	

CLAIM 40

PARCEL	AREA (Acres)
31-080-11	26.51
Total = 26.51 acres	

*On February 13th, 1989 the U.S. District Court changed the place of use of a portion of claim 55 and all of claim 464 and split claim 55 into two claims, 55a and 55b. The following table shows the new place of use of claims 55 & 464.

CLAIM	PRIORITY	IRRIGATED ACRES	PLACE OF USE	SEC	TWP	RNG
55a	1860	200.00		21	11	20
				22		
				28		
				15		
			S $\frac{1}{2}$	10		
	1871	53.40		21	11	20
				22		
				28		
				15		
			S $\frac{1}{2}$	10		
55b		6.60	E $\frac{1}{2}$ SE $\frac{1}{4}$	3	(not specified)	
		30.00	E $\frac{1}{2}$ SW $\frac{1}{4}$	3		
464	1879	228.00		21	11	20
				22		
				28		
				15		
			S $\frac{1}{2}$	10		



This map is solely for the purpose of describing acreage to which water rights were allocated by the final decree in the United States vs. Alpine Land & Reservoir Company, et al., D-183 BRT, and for no other purpose. The map is based upon the State Engineer's and the Federal Water Master's interpretation of the final decree and other information available in the State Engineer's and the Federal Water Master's office as of the date of this approval. This map should not be relied upon as a legal description of any specific parcel.

APPROVED BY THE STATE ENGINEER:
 s/R. Michael Turnipseed, P.E. 12/30/99
 R. Michael Turnipseed, P.E. Date

APPROVED BY THE FEDERAL WATER MASTER:
 s/Garry D. Stone 12/29/99
 Garry D. Stone Date

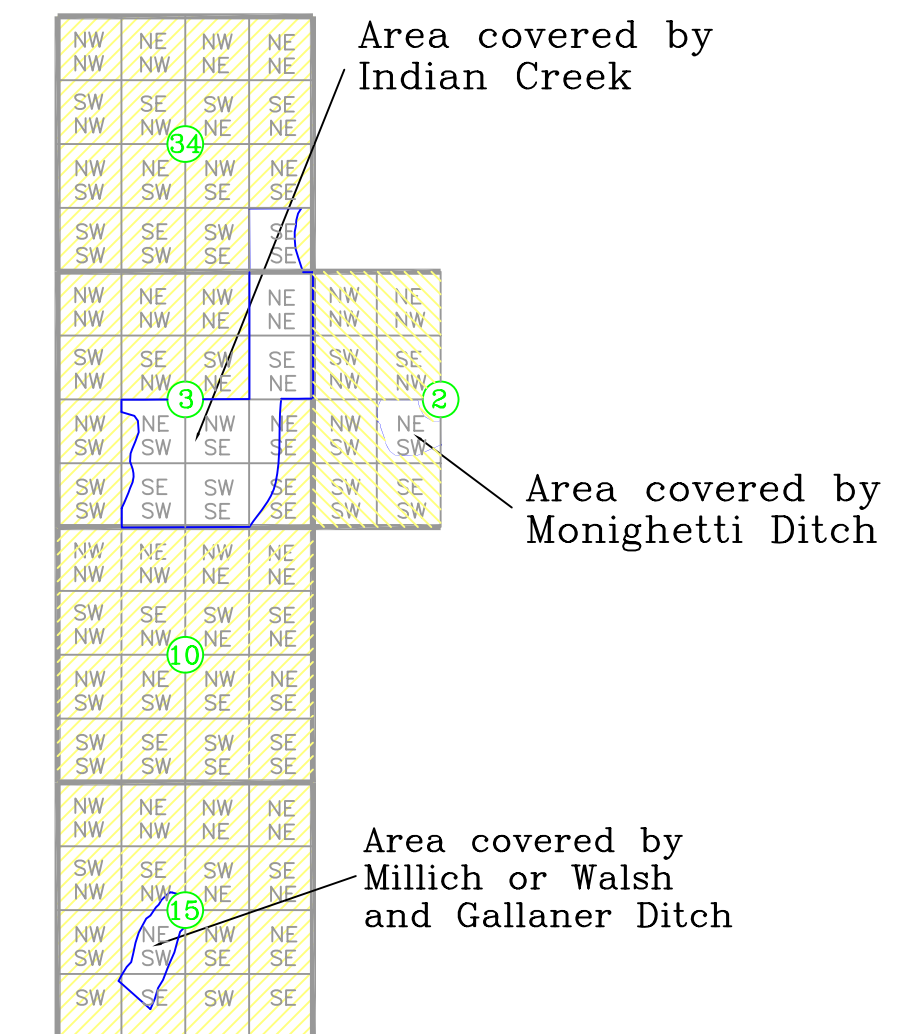

PORTION OF SECTION COVERED BY THIS SHEET



LEGEND

- lot/parcel line
- block boundary
- decree claim boundary
- section } Public Land Survey
- 1/4 section } System (PLSS) lines
- 1/4 1/4 section }
- creek/ditch
- area not containing Alpine decreed water rights
- ▨ water rights completely stripped by permit/certificate
- 31-080 Douglas County Assessor's parcel number (APN)
- block page book
- 99 lot number

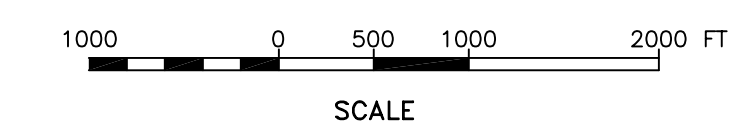

CHECKED BY		STATE of NEVADA
SECTION CHIEF		Division of Water Resources
PROJECT SUPERVISOR		123 W. Nye Ln., Carson City NV 89710
F.W.M. OFFICE REVIEWER		DRAWING NO.: CR-028
		DRAWN BY: M. McCALL DATE: 03/19/98